



Manufactured by Alloy Product Corp in USA and supplied in Europe by SR-TEK, the range of ASME, Pharmaceutical and UN portable stainless steel pressure vessels are designed to meet a diverse range of applications and industries. From general purpose applications to fluid handling in the chemical, life science, pharmaceutical, semi-conductor, electronic, dairy, food and beverage industries.

The vessels fluid capacities range from 3.8L to 141.5L., Larger sizes can be available on request.

All models can also be fitted with air agitators, gauges, fittings, dip tube and special size tubes. Different surface finish can also be provided for each model



### LT Series ASME Lightweight Pressure vessels

- From 1.4L to 60.8L capacity
- 4 ¼" NTP female pipe fittings
- Stainless steel skirt with removable rubber boot
- Available with Small or large oval pressure closure
- Available in Stainless steel 304 or 316
- Standard white pickle finish or electropolish finish
- Supplied with or without air management system



### HY Series Pharmaceutical/Hygienic Lightweight Pressure vessels

- Available in 19L and 37.8L capacity (contact us for custom sizes)
- Low carbon stainless steel 316 electropolish finish
- Rated for full vacuum
- 5 Sanitary clamp type fittings
- Additional ports and size of ports can be added on request
- Rugged reinforced stainless steel skirt
- Chromium-rich stainless steel for maximum passivity
- Permanent stainless steel handles



### UN Series Portable Pressure vessels

- Pre-tested available sizes are 3.8L, 11.4L, 19L and 209L capacity
- Contact us for custom sizes
- Built in compliance with UN/DT 49 CFR non-bulk packaging
- 4 ¼" NTP female pipe fittings
- White pickle finish
- Stainless steel skirt with removable rubber boot on all 9" models
- Ring chimes for protection of fittings and ease of transport
- Built-in skids in 209L model
- Chromium-rich stainless steel for maximum passivity



Subject to change without notice.

For more information, please contact us at [technical@sr-tek.com](mailto:technical@sr-tek.com)

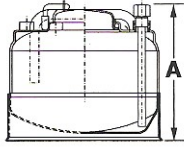
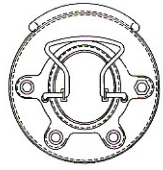

8" / 203.2mm ID		SPECIFICATIONS MODEL 72			
Reference	Capacity (L/Gal)	"A" Dimension	Weight (Kg)	Max. Temp.* (°C)	Max. Pressure (psi/Bar)
1400ML-LTSS	1.4 / 0.37	132.6mm	3.1	37.8	185 / 12.7

8" / 203.2mm ID		SPECIFICATIONS MODEL 74			
Reference	Capacity (L/Gal)	"A" Dimension	Weight (Kg)	Max. Temp.* (°C)	Max. Pressure (psi/Bar)
1400ML-LTSS	1.4 / 0.37	132.6mm	3.1	37.8	132 / 9.1

\*Higher operating temperatures are achievable, pressure dependent. Contact us for further information

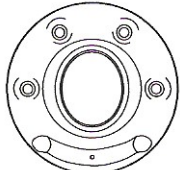

Model 72  
Standard Opening  
3.25" x 3.875"

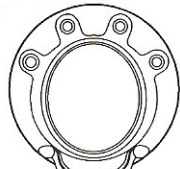

Model 74  
Wide Mouth  
4.875" x 5.875"

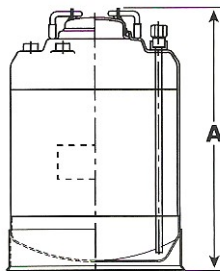

9" / 228.6mm ID		SPECIFICATIONS MODEL 72			
Reference	Capacity (L/Gal)	"A" Dimension	Weight (Kg)	Max. Temp.* (°C)	Max. Pressure (psi/Bar)
3800ML-LT	3.8 / 1	216.0mm	4.5	37.8	205 / 14.1
3800ML-LTSS	3.8 / 1	216.0mm	4.5	37.8	185 / 12.7
7600ML-LT	7.6 / 2	295.2mm	6.0	37.8	205 / 14.1
7600ML-LTSS	7.6 / 2	295.2mm	6.0	37.8	185 / 12.7
1140ML-LT	11.4 / 3	387.3mm	7.0	37.8	198 / 13.6
1140ML-LTSS	11.4 / 3	387.3mm	7.0	37.8	185 / 12.7
1900ML-LT	19.0 / 5	571.5mm	9.1	37.8	195 / 13.5
1900ML-LTSS	19.0 / 5	571.5mm	9.1	37.8	185 / 12.7

9" / 228.6mm ID		SPECIFICATIONS MODEL 74			
Reference	Capacity (L/Gal)	"A" Dimension	Weight (Kg)	Max. Temp.* (°C)	Max. Pressure (psi/Bar)
3800ML-LT	3.8 / 1	216.0mm	4.5	37.8	132 / 9.1
3800ML-LTSS	3.8 / 1	216.0mm	4.5	37.8	132 / 9.1
7600ML-LT	7.6 / 2	295.2mm	6.0	37.8	132 / 9.1
7600ML-LTSS	7.6 / 2	295.2mm	6.0	37.8	132 / 9.1
1140ML-LT	11.4 / 3	387.3mm	7.0	37.8	132 / 9.1
1140ML-LTSS	11.4 / 3	387.3mm	7.0	37.8	132 / 9.1
1900ML-LT	19.0 / 5	571.5mm	9.1	37.8	132 / 9.1
1900ML-LTSS	19.0 / 5	571.5mm	9.1	37.8	132 / 9.1

\*Higher operating temperatures are achievable, pressure dependent. Contact us for further information

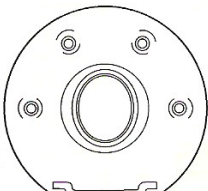

Model 73  
Standard Opening  
3.25" x 3.875"

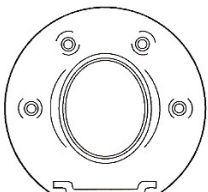

Model 75  
Wide Mouth  
4.875" x 5.875"

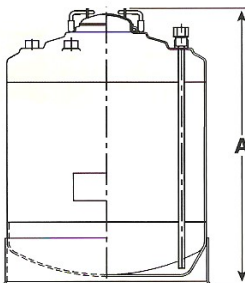

12" / 304.8mm ID		SPECIFICATIONS MODEL 73			
Reference	Capacity (L/Gal)	"A" Dimension	Weight (Kg)	Max. Temp.* (°C)	Max. Pressure (psi/Bar)
3780CL-LT	37.8 / 10	643.0mm	15.4	37.8	165 / 11.4
3780CL-LTSS	37.8 / 10	643.0mm	15.4	37.8	165 / 11.4
6000CL-LT	60.8 / 16	952.0mm	21.0	37.8	165 / 11.4
6000CL-LTSS	60.8 / 16	952.0mm	21.0	37.8	165 / 11.4

12" / 304.8mm ID		SPECIFICATIONS MODEL 75			
Reference	Capacity (L/Gal)	"A" Dimension	Weight (Kg)	Max. Temp.* (°C)	Max. Pressure (psi/Bar)
3780CL-LT	37.8 / 10	643.0mm	15.4	37.8	125 / 8.6
3780CL-LTSS	37.8 / 10	643.0mm	15.4	37.8	115 / 7.9
6000CL-LT	60.8 / 16	952.0mm	21.0	37.8	125 / 8.6
6000CL-LTSS	60.8 / 16	952.0mm	21.0	37.8	115 / 7.9

\*Higher operating temperatures are achievable, pressure dependent. Contact us for further information

All 9" and 12" vessels can be ordered in either 304 or 316 stainless steel. Model 1400ML-LTSS is available in 316 stainless only. All general purpose vessels can be ordered electropolished for an additional charge. Please contact us for any further information, technical drawings, prices and lead time.



All Alloy Products Pharmaceutical/Hygienics pressure vessels are rated for full vacuum and meet the American Society of Mechanical Engineers (ASME) "U" or "UM" Code for Unified Pressure Vessels Section VIII, Division 1.

### HY Series Pharmaceutical/Hygienic Lightweight Pressure vessels

- Available in 19L and 37.8L capacity (contact us for custom sizes)
- Low carbon stainless steel 316 electropolish finish
- Rated for full vacuum
- 5 Sanitary clamp type fittings
- Additional ports and size of ports can be added on request
- Rugged reinforced stainless steel skirt
- Chromium-rich stainless steel for maximum passivity
- Permanent stainless steel handles

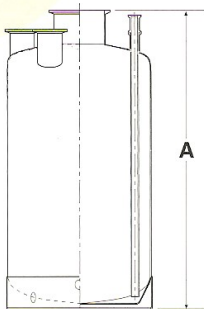
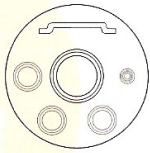

### 9" / 228.6mm ID

### SPECIFICATIONS

Reference	Capacity (L/Gal)	"A" Dimension	Weight (Kg)	Max. Temp.* (°C)	Max. Pressure (psi/Bar)
1900ML-HY	19 / 5	571.5mm	9.1	37.8	135 / 9.3

\*Higher operating temperatures are achievable, pressure dependent. Contact us for further information

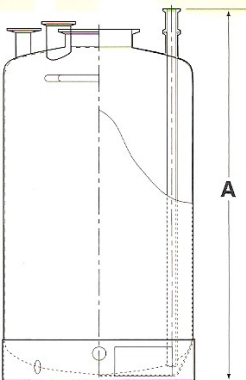
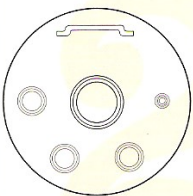

### 12" / 304.8mm ID

### SPECIFICATIONS

Reference	Capacity (L/Gal)	"A" Dimension	Weight (Kg)	Max. Temp.* (°C)	Max. Pressure (psi/Bar)
3780CL-HY	37.8 / 10	643.0mm	15.4	37.8	125 / 8.6

\*Higher operating temperatures are achievable, pressure dependent. Contact us for further information

In addition to our stock vessels, SR-TEK can also offers a full array of custom configuratons, designed specifically for your application. Available in 9", 12" or 18" (229, 305 or 458mm) diameters, with a total volume range from 3.8 to 141.5 Litres (1 to 37.4Gal). Our supplier can design create and fabricate a wide variety of high-quality vessels to your exact specifications. Please contact us to request more informaiton or discuss your requirements.



Rugged Alloy Product UN pressure vessels are designed and built to perform reliably for the world's most demanding users, in challenging transport situations around the globe. They live up to rigorous United Nations standards and Alloy Products' reputation for quality and long life.

All UN pressure vessels manufactured by Alloy Products undergo the following tests:

- Drop Test Subpart M, Section 178.603
- Leak-Proof Test Subpart M, Section 178.604
- Hydrostatic Test Subpart M, Section 178.605
- Stacking Test Subpart M, Section 178.606
- Vibration Test Subpart M, Section 178.608
- Periodic Retesting Subpart M, Section 178.601(e)

### UN Series Portable Pressure vessels

- Pre-tested available sizes are 3.8L, 11.4L, 19L and 209L capacity
- Contact us for custom sizes
- Built in compliance with UN/DT 49 CFR non-bulk packaging
- 4 1/4" NTP female pipe fittings
- White pickle finish
- Stainless steel skirt with removable rubber boot on all 9" models
- Ring chimes for protection of fittings and ease of transport
- Built-in skids in 209L model
- Chromium-rich stainless steel for maximum passivity

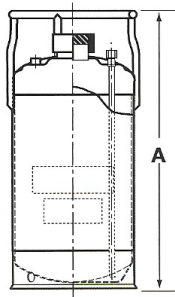
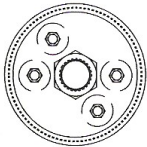

9" / 228.6mm ID		SPECIFICATIONS			
Reference	Capacity (L/Gal)	"A" Dimension	Weight (Kg)	Max. Temp.* (°C)	Max. Pressure (psi/Bar)
3800ML-UN	3.8 / 1	273mm	4.5	37.8	185 / 12.7
1140ML-UN	11.4 / 3	432mm	7.0	37.8	185 / 12.7
1900ML-UN	19 / 5	616mm	9.1	37.8	185 / 12.7

\*Higher operating temperatures are achievable, pressure dependent. Contact us for further information

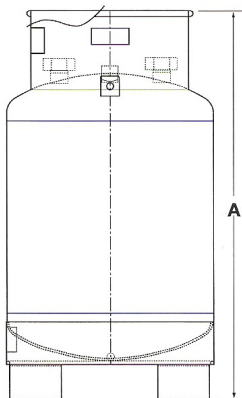
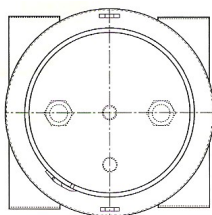

24" / 609.6mm ID		SPECIFICATIONS			
Reference	Capacity (L/Gal)	"A" Dimension	Weight (Kg)	Max. Temp.* (°C)	Max. Pressure (psi/Bar)
2090DL-UN	209 / 55	1,141mm	230	37.8	72 / 4.9

\*Higher operating temperatures are achievable, pressure dependent. Contact us for further information

In addition to our stock vessels, SR-TEK can also offers a full array of custom configuratons, designed specifically for your application. Available in 9", 12" or 18" (229, 305 or 458mm) diameters, with a total volume range from 3.8 to 141.5 Liters (1 to 37.4Gal). Our supplier can design create and fabricate a wide variety of high-quality vessels to your exact specifications. Please contact us to request more informaiton or discuss your requirements.